

WINDSOR AVE (40-FT)

CB
RIM = 124.85
INV. = 122.44 (12" HDPE)

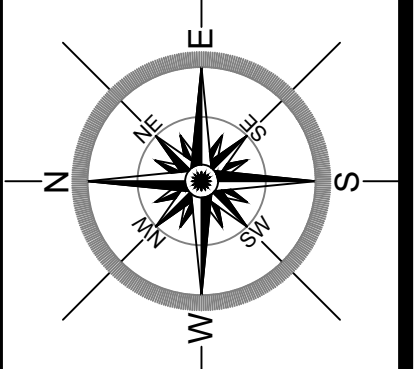
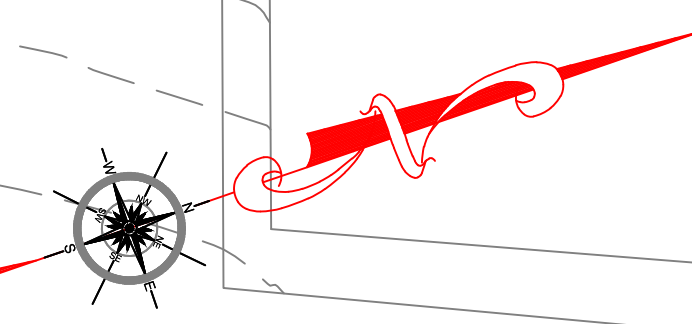
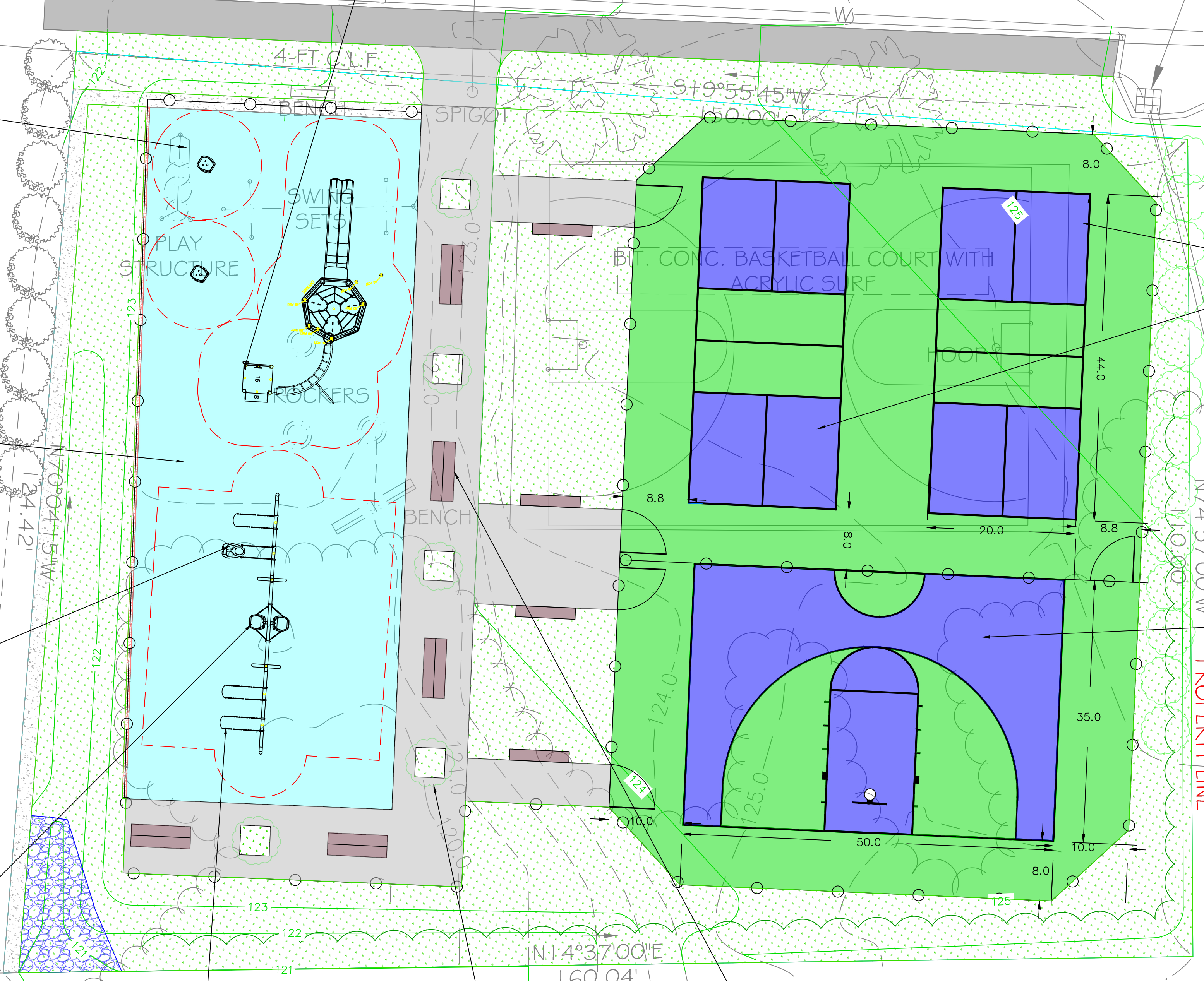
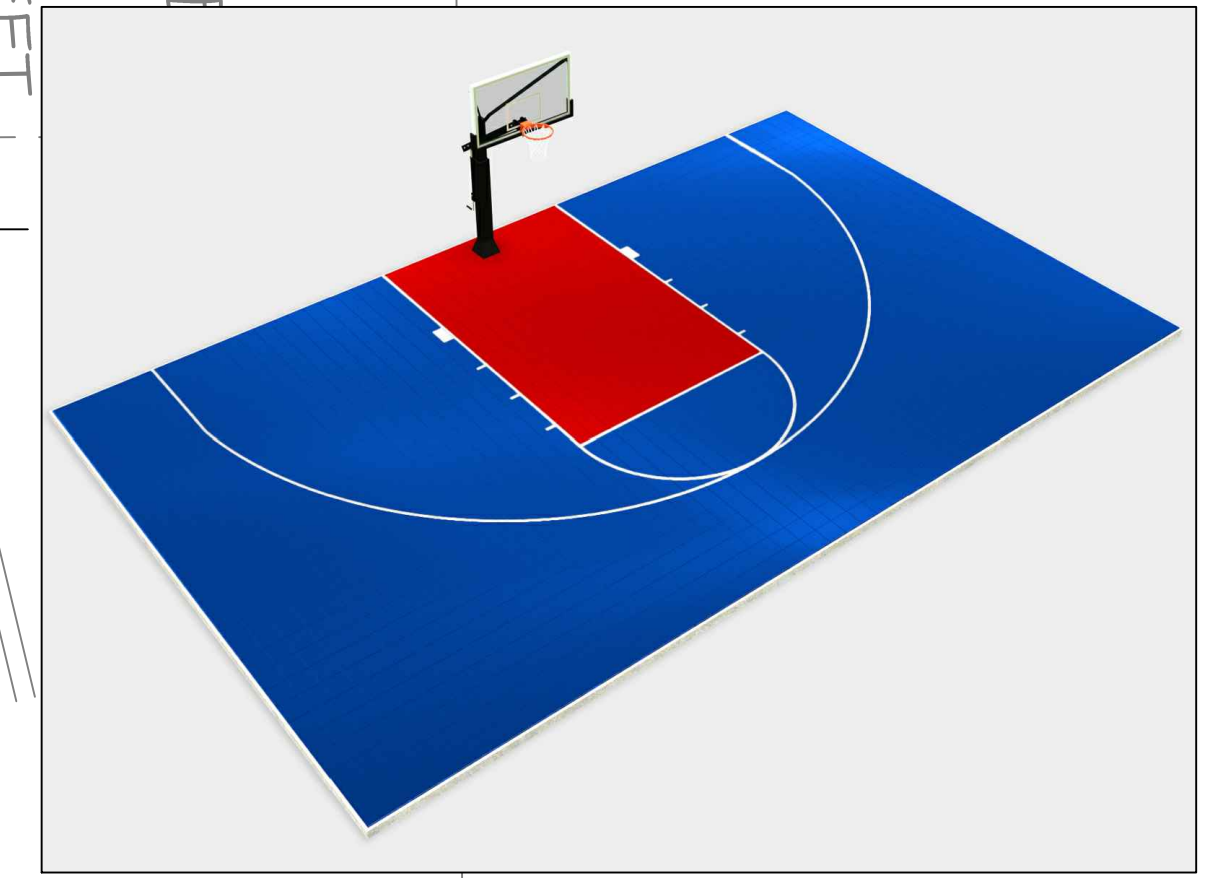

**NESRA
ENGINEERING, LLC**

P.O. BOX 533
EAST TAUNTON, MA 02718
(617) 506-3772
WWW.NESRAENG.COM

Project
**ATHLETIC COURT AND
PLAYGROUND
RENOVATION PROJECT,
WINDSOR AVENUE,
SWAMPSCOTT, MA**

Client
**TOWN OF SWAMPSCOTT
DEPARTMENT OF
COMMUNITY AND
ECONOMIC DEVELOPMENT
22 MONUMENT AVE,
SWAMPSCOTT, MA 01907**

No.	Revision	Date

Scale: 1"=10'-0"
Date: 06/11/21
Professional Seal

**SCHEMATIC
DESIGN**

C-1

