

KING'S BEACH

SEAWALL REPAIRS

SWAMPSCOTT, MA



GENERAL NOTES

GENERAL REQUIREMENTS

- A. Prior to bidding, all bidders must view the premises and note conditions at and around where work is to be performed. Bidders shall fully inform themselves of all conditions affecting the work of this project.
- B. Refer to the Project Specifications for the General Conditions of the Contract for Construction, for the general requirements, and for the detailed requirements for materials and workmanship.
- C. The dimensions of the seawall and typical sections are approximate. The contractor shall field verify all existing conditions, including the configuration of all structural elements affecting the work.
- D. The Drawings show the approximate location of concrete deterioration. The contractor is responsible for visually inspecting and sounding all accessible concrete surfaces as required to discover and repair all concrete deterioration in accordance with the drawings and project specifications.
- E. Discrepancies and conflicts between the repairs and new elements, and the existing structure shall be brought to the attention of the engineer prior to the fabrication and construction of dependent work.
- F. Phased Construction
 - 1. The Work shall be conducted in phases to maintain public beach egress and access throughout construction. The Contractor shall provide proposed phasing plans and an overall project schedule for Owner review and approval.

SCOPE OF WORK

- A. The work contemplated by the Contract Documents includes the work of all trades required and all labor, equipment, materials, access, and supervision necessary and incidental to the work indicated. The following descriptions of the work represent a brief summary of the project. For additional and more complete information, refer to the Drawings and Specifications.
 - 1. Project Mobilization
 - a. This work shall include General Contractor and subcontractor mobilization costs. Include permits, temporary offices, bonding costs, etc.
 - 2. Project General Requirements
 - a. This work shall include all miscellaneous work associated with the completion of the work in accordance with the Construction Documents. This shall include but not be limited to incidental shoring, barricades, debris containment, cleanup, dust and fume control, layout, equipment, waste disposal, documentation, obstruction removal and replacement, monthly as-built documents, and temporary heat, water, and utilities.
 - b. The Contractor shall coordinate construction phasing with the Owner.

B. Concrete Repair:

- a. Remove deteriorated and sound concrete to a minimum depth of 2 in. from the original wall surfaces.
- b. Prepare the concrete surface to receive a shotcrete overlay.
- c. Install shotcrete overlay (depth varies). Place GFRP bars and hooks where required.

C. Joint Sealants:

- 1. Install new joint sealant and backer rod at existing control joints in concrete curb at locations shown on the Drawings.

DRAWING LIST

C-0	COVER SHEET
E-0	EXISTING CONDITIONS
S-1	TYPICAL REPAIR DETAILS
S-2	SEAWALL REPAIR ELEVATIONS SECTIONS 1 & 2
S-3	SEAWALL REPAIR ELEVATIONS SECTIONS 3 & 4
S-4	SEAWALL REPAIR ELEVATIONS SECTIONS 5 & 6
S-5	SEAWALL REPAIR ELEVATIONS SECTIONS 7 & 8
S-6	SEAWALL REPAIR ELEVATIONS SECTIONS 9 & 10
S-7	SEAWALL REPAIR ELEVATIONS SECTIONS 11 & 12
S-8	SEAWALL REPAIR ELEVATIONS SECTIONS 13 & 14
S-9	SEAWALL REPAIR ELEVATIONS SECTIONS 15

SIMPSON GUMPERTZ & HEGER
 Engineering of Structures
 and Building Enclosures

Boston
 Chicago
 Houston
 Los Angeles
 New York
 San Francisco
 Washington, DC

Simpson Gumpertz & Heger Inc.
 800 Boylston Street, Suite 2320
 Boston, Massachusetts 02119
 main: 617.963.5400 fax: 617.963.5401
 www.sgh.com

Consultant

BID SET

No.	Date	Description	By

SEAWALL REPAIRS
KING'S BEACH
SWAMPSCOTT, MA

Project

COVER SHEET

Drawing Title

Project No. 200603.00	Checked JGT	Date 07/10/2020
Drawn ZCL	Approved GGC	Scale AS NOTED
Seal		Drawing No. C-1



KEY PLAN

N.T.S.

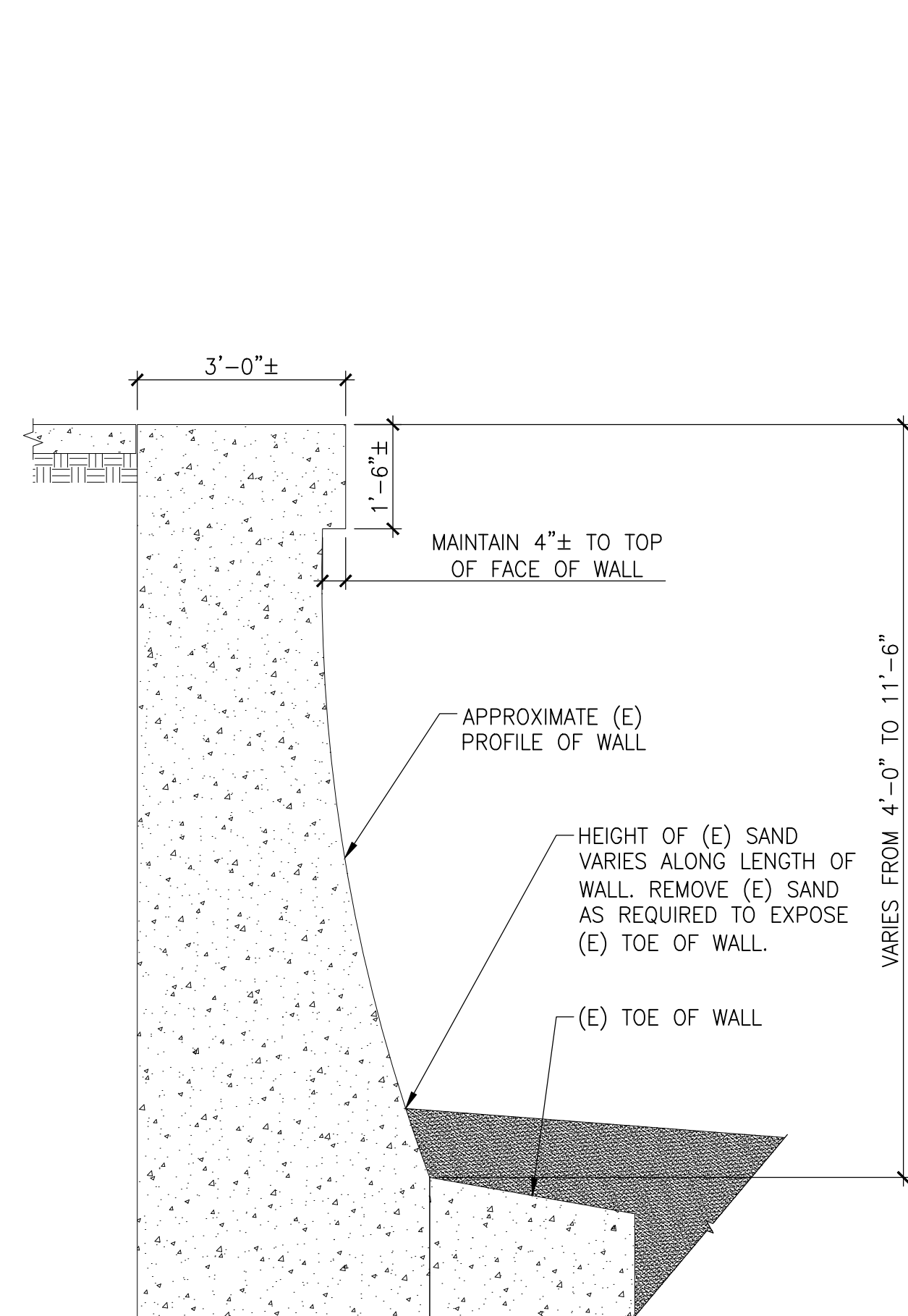

APPROXIMATE SEAWALL SECTION – WALL SECTIONS 1-12

E1

1/2" = 1'-0"

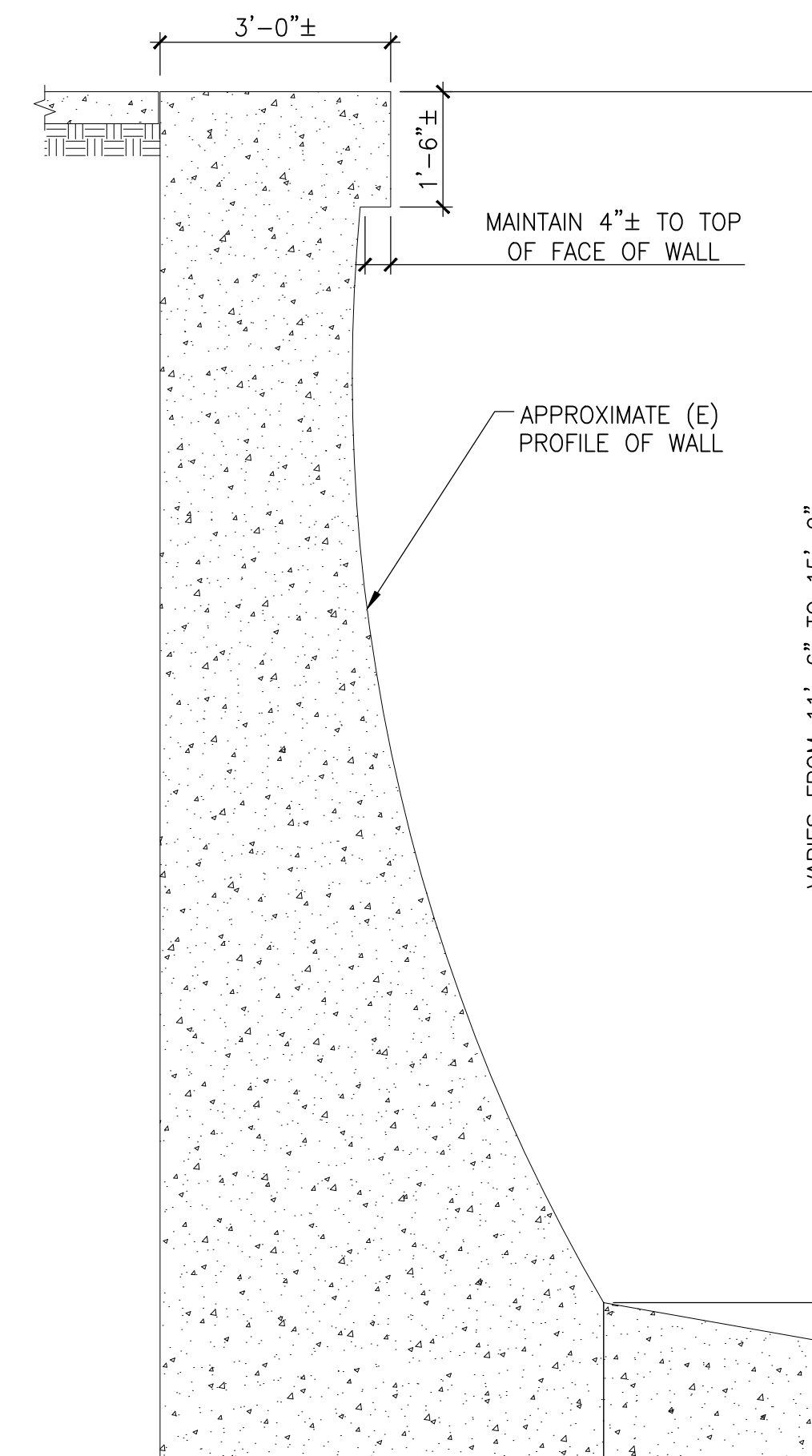

APPROXIMATE WALL SECTION – WALL SECTIONS 13-15

E2

1/2" = 1'-0"

Consultant

BID SET

No.	Date	Description	By

**SEAWALL REPAIRS
KING'S BEACH
SWAMPSCOTT, MA**

Project

**KEYPLAN AND
TYPICAL SEAWALL
SECTIONS**

Drawing Title

Project No. 200603.00	Checked JGT	Date 07/10/2020
Drawn ZCL	Approved GGC	Scale AS NOTED

Seal

Drawing No.

C-2

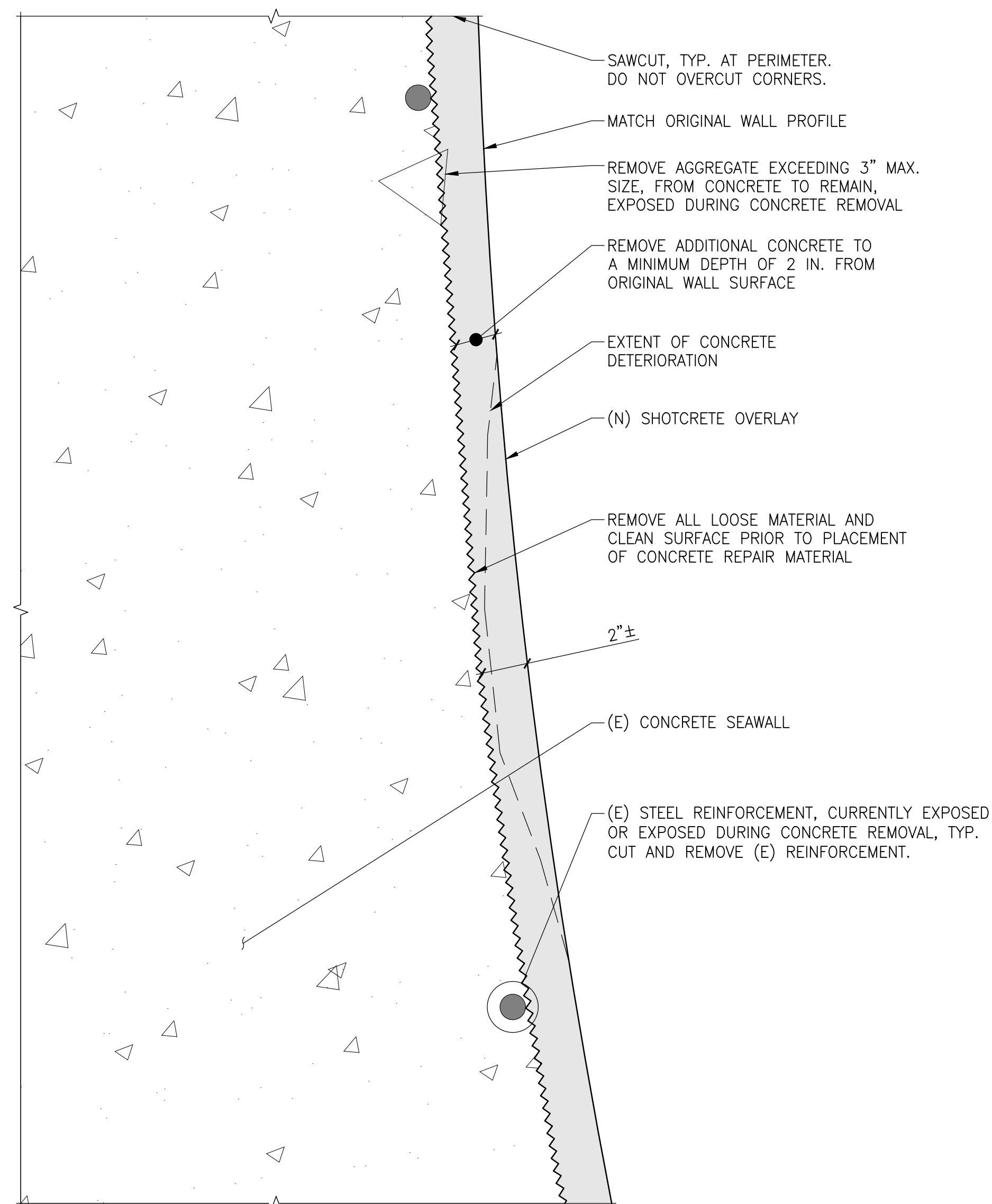

1 SHALLOW CONCRETE REPAIR DETAIL 3" = 1'-0"

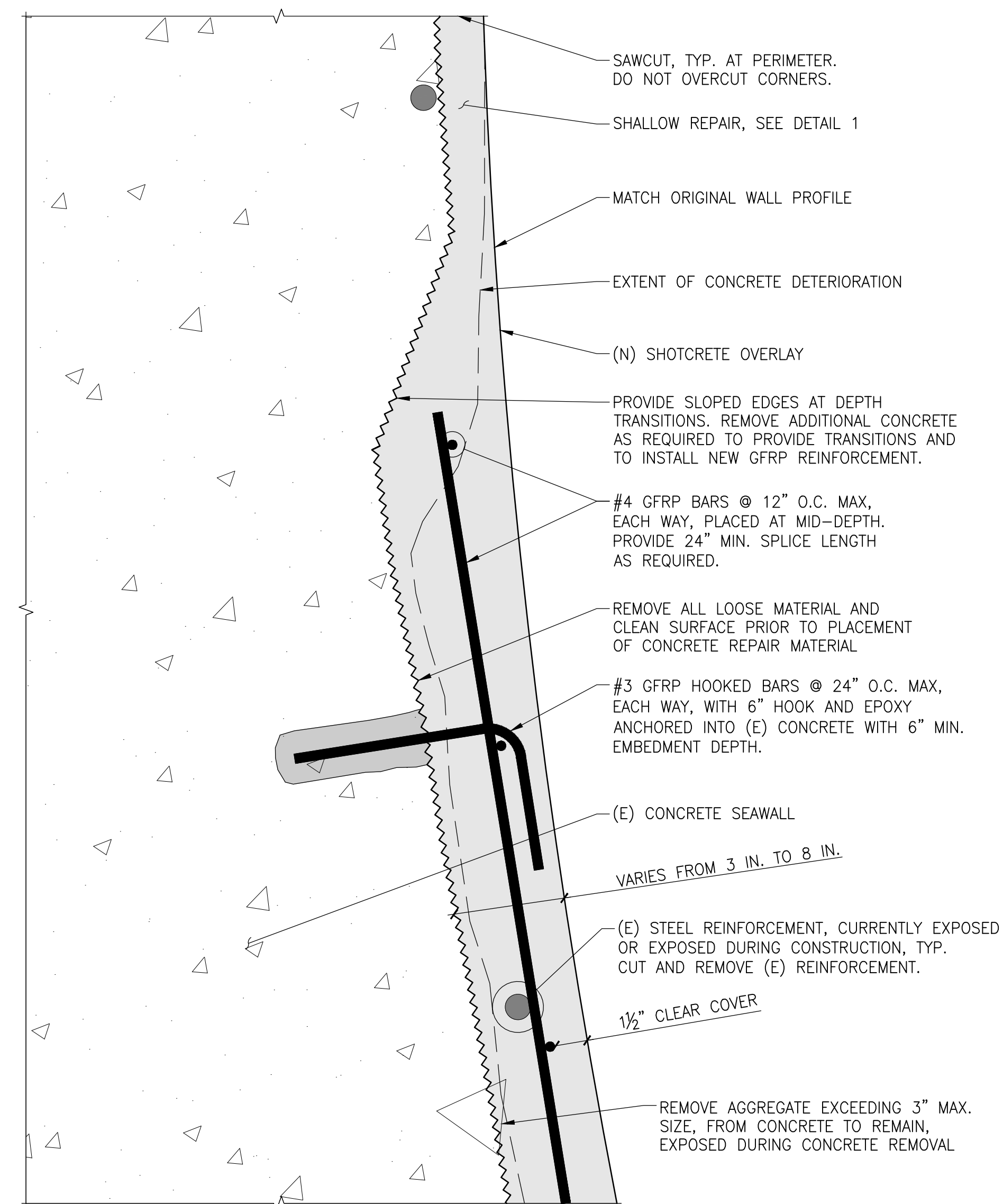

2 DEEP CONCRETE REPAIR DETAIL 3" = 1'-0"

Consultant

No.	Date	Description	By

**SEAWALL REPAIRS
KING'S BEACH
SWAMPSCOTT, MA**

Project

**TYPICAL REPAIR
DETAILS**

Drawing Title

Project No. 200603.00	Checked JGT	Date 07/10/2020
Drawn ZCL	Approved GGC	Scale AS NOTED

Drawing No.

Seal

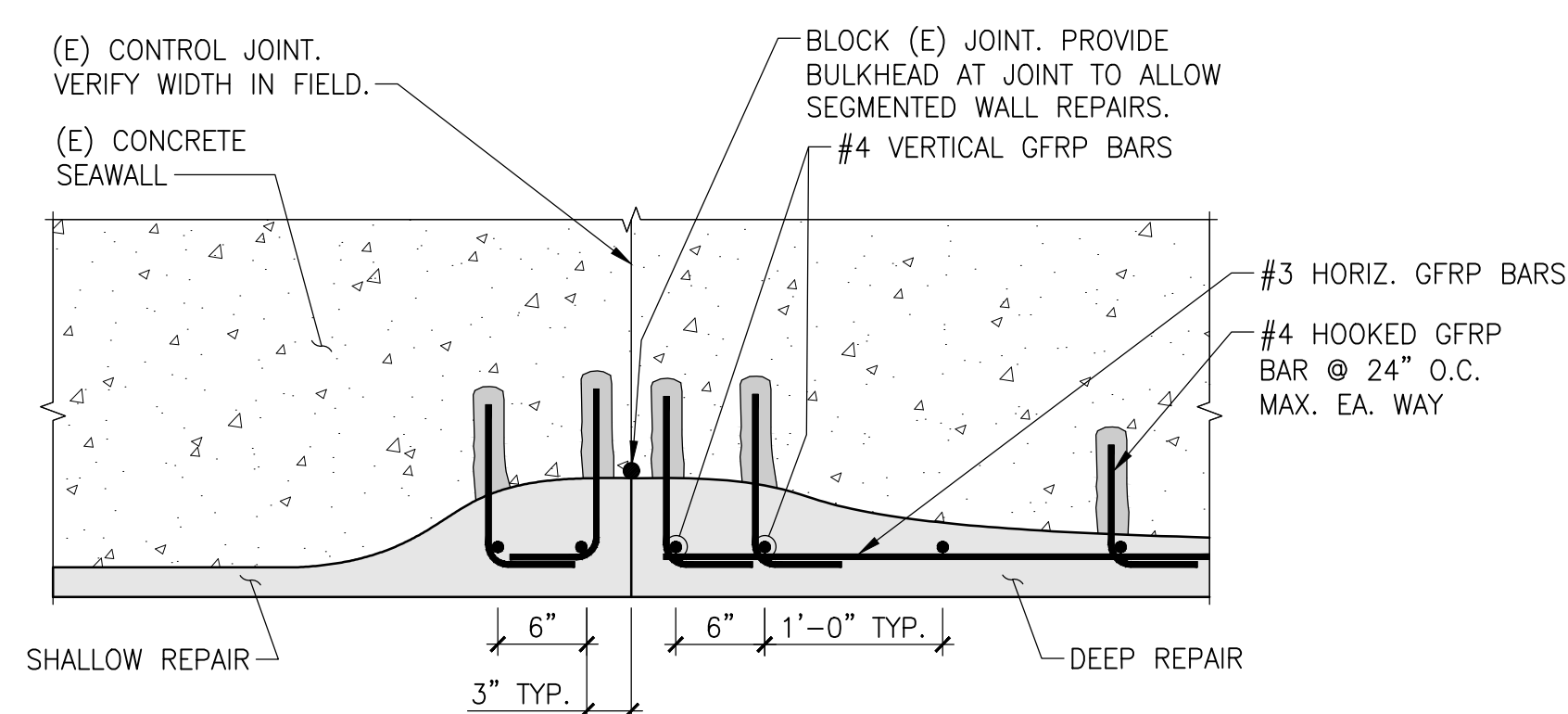

3 CONCRETE REPAIR AT CONTROL JOINT N.T.S.

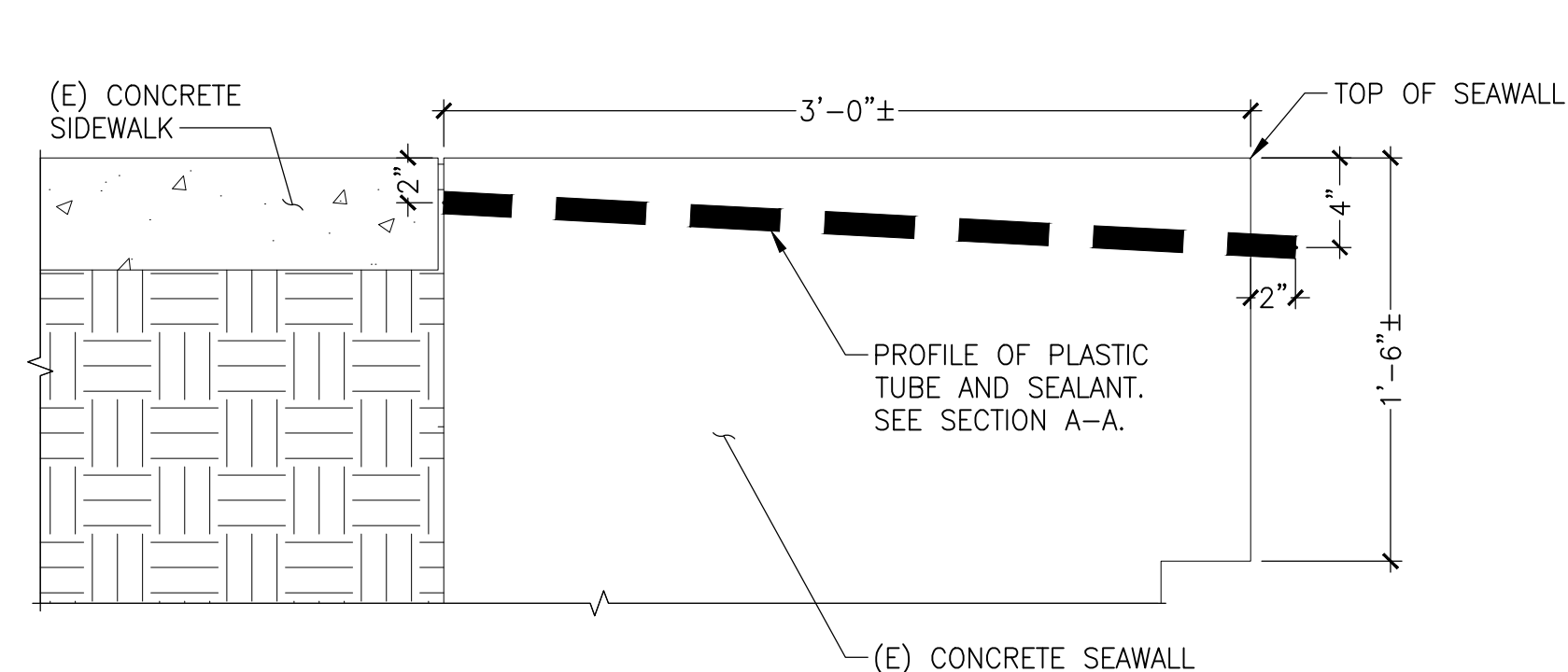

4 JOINT WATERPROOFING AT TOP OF SEAWALL N.T.S.

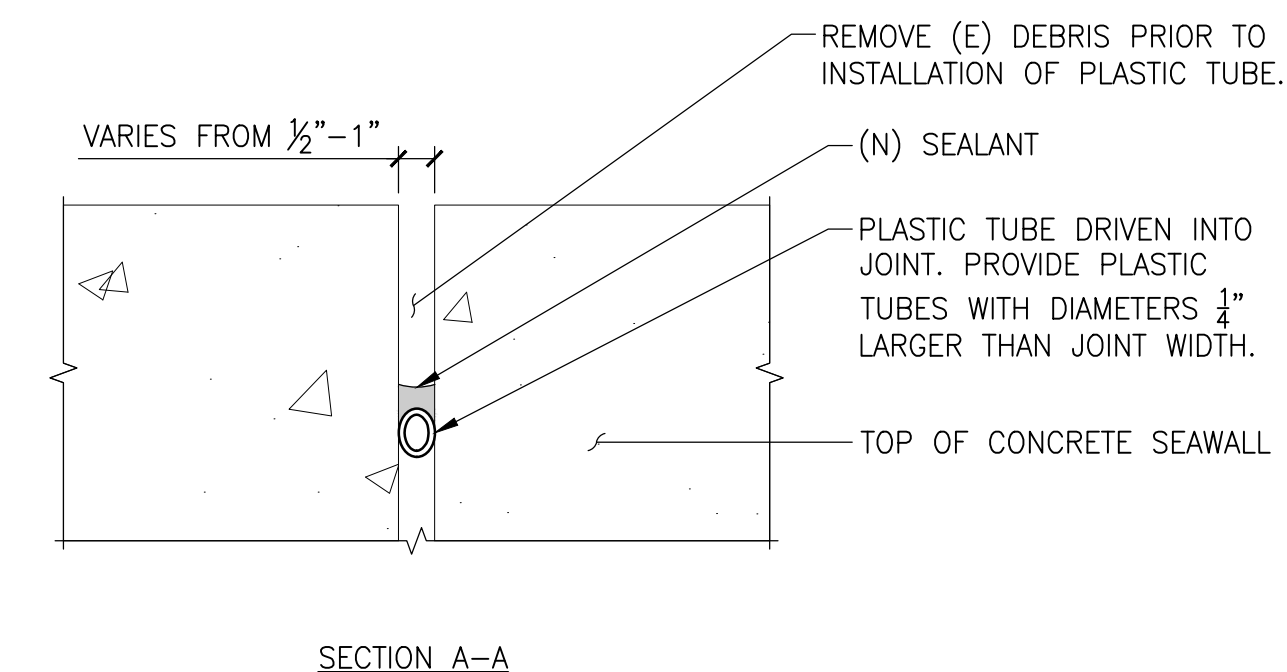

SECTION A-A

BID SET

S-1



Consultant



APPROXIMATE EXTENTS OF SECTION 1

(E) CONTROL JOINT,
SEE DETAIL 4/S-1

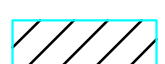
LEGEND:

-  INDICATES APPROXIMATE LOCATION AND EXTENTS OF SHALLOW CONCRETE REPAIR (SEE DETAIL 1/S-1). QUANTITY: 560 SF
-  INDICATES APPROXIMATE LOCATION AND EXTENTS OF DEEP CONCRETE REPAIR EXTENDING UP TO 4 IN. FROM ORIGINAL FACE OF WALL (SEE DETAIL 2/S-1). QUANTITY: 20 SF
-  INDICATES APPROXIMATE LOCATION AND EXTENTS OF DEEP CONCRETE REPAIR EXTENDING GREATER THAN 4 IN. FROM ORIGINAL FACE OF WALL (SEE DETAIL 2/S-1). QUANTITY: 20 SF



SEAWALL REPAIR ELEVATION - SECTION 1

N.T.S.



APPROXIMATE EXTENTS OF SECTION 2

(E) CONTROL JOINT,
SEE DETAIL 4/S-1

LEGEND:

-  INDICATES APPROXIMATE LOCATION AND EXTENTS OF SHALLOW CONCRETE REPAIR (SEE DETAIL 1/S-1). QUANTITY: 500 SF

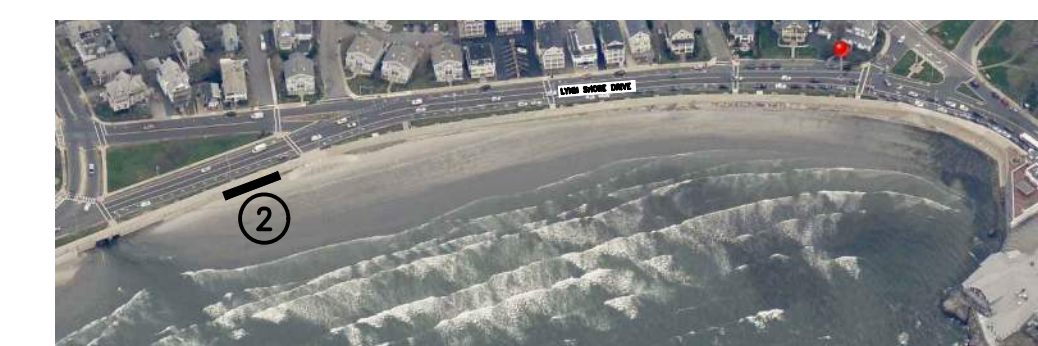

SEAWALL REPAIR ELEVATION - SECTION 2

N.T.S.

BID SET

No.	Date	Description	By

**SEAWALL REPAIRS
KING'S BEACH
SWAMPSCOTT, MA**

Project

**SEAWALL REPAIR
ELEVATIONS
SECTIONS 1 & 2**

Drawing Title

Project No. 200603.00	Checked JGT	Date 07/10/2020
Drawn ZCL	Approved GGC	Scale AS NOTED

Seal	Drawing No.
	S-2



APPROXIMATE EXTENTS OF SECTION 3

(E) CONTROL JOINT,
SEE DETAIL 4/S-1

LEGEND:

- INDICATES APPROXIMATE LOCATION AND EXTENTS OF SHALLOW CONCRETE REPAIR (SEE DETAIL 1/S-1). QUANTITY: 190 SF
- INDICATES APPROXIMATE LOCATION AND EXTENTS OF DEEP CONCRETE REPAIR EXTENDING UP TO 4 IN. FROM ORIGINAL FACE OF WALL (SEE DETAIL 2/S-1). QUANTITY: 10 SF



SEAWALL REPAIR ELEVATION – SECTION 3

N.T.S.



APPROXIMATE EXTENTS OF SECTION 4

(E) CONTROL JOINT,
SEE DETAIL 4/S-1

LEGEND:

- INDICATES APPROXIMATE LOCATION AND EXTENTS OF SHALLOW CONCRETE REPAIR (SEE DETAIL 1/S-1). QUANTITY: 355 SF
- INDICATES APPROXIMATE LOCATION AND EXTENTS OF DEEP CONCRETE REPAIR EXTENDING GREATER THAN 4 IN. FROM ORIGINAL FACE OF WALL (SEE DETAIL 2/S-1). QUANTITY: 15 SF



SEAWALL REPAIR ELEVATION – SECTION 4

N.T.S.

SIMPSON GUMPERTZ & HEGER
Engineering of Structures
and Building Enclosures

Boston
Chicago
Houston
Los Angeles
New York
San Francisco
Washington, DC

Simpson Gumpertz & Heger Inc.
800 Boylston Street, Suite 2320
Boston, Massachusetts 02199
Phone: 617.963.5400 Fax: 617.963.5401
www.sgh.com

Consultant

No.	Date	Description	By

**SEAWALL REPAIRS
KING'S BEACH
SWAMPSCOTT, MA**

Project

**SEAWALL REPAIR
ELEVATIONS
SECTIONS 3 & 4**

Drawing Title

Project No. 200603.00	Checked JGT	Date 07/10/2020
Drawn ZCL	Approved GGC	Scale AS NOTED
Seal		Drawing No. S-3

BID SET



LEGEND:

- INDICATES APPROXIMATE LOCATION AND EXTENTS OF SHALLOW CONCRETE REPAIR (SEE DETAIL 1/S-1). QUANTITY: 800 SF
- INDICATES APPROXIMATE LOCATION AND EXTENTS OF DEEP CONCRETE REPAIR EXTENDING UP TO 4 IN. FROM ORIGINAL FACE OF WALL (SEE DETAIL 2/S-1). QUANTITY: 30 SF



SEAWALL REPAIR ELEVATION – SECTION 7

N.T.S.



LEGEND:

- INDICATES APPROXIMATE LOCATION AND EXTENTS OF SHALLOW CONCRETE REPAIR (SEE DETAIL 1/S-1). QUANTITY: 700 SF
- INDICATES APPROXIMATE LOCATION AND EXTENTS OF DEEP CONCRETE REPAIR EXTENDING UP TO 4 IN. FROM ORIGINAL FACE OF WALL (SEE DETAIL 2/S-1). QUANTITY: 75 SF
- INDICATES APPROXIMATE LOCATION AND EXTENTS OF DEEP CONCRETE REPAIR EXTENDING GREATER THAN 4 IN. FROM ORIGINAL FACE OF WALL (SEE DETAIL 2/S-1). QUANTITY: 75 SF



SEAWALL REPAIR ELEVATION – SECTION 8

N.T.S.

Consultant

No.	Date	Description	By

**SEAWALL REPAIRS
KING'S BEACH
SWAMPSCOTT, MA**

Project

**SEAWALL REPAIR
ELEVATIONS
SECTIONS 7 & 8**

Drawing Title

Project No. 200603.00	Checked JGT	Date 07/10/2020
Drawn ZCL	Approved GGC	Scale AS NOTED

Drawing No.

S-5

Seal

BID SET



LEGEND:

- INDICATES APPROXIMATE LOCATION AND EXTENTS OF SHALLOW CONCRETE REPAIR (SEE DETAIL 1/S-1). QUANTITY: 775 SF
- INDICATES APPROXIMATE LOCATION AND EXTENTS OF DEEP CONCRETE REPAIR EXTENDING UP TO 4 IN. FROM ORIGINAL FACE OF WALL (SEE DETAIL 2/S-1). QUANTITY: 50 SF
- INDICATES APPROXIMATE LOCATION AND EXTENTS OF DEEP CONCRETE REPAIR EXTENDING GREATER THAN 4 IN. FROM ORIGINAL FACE OF WALL (SEE DETAIL 2/S-1). QUANTITY: 75 SF



SEAWALL REPAIR ELEVATION - SECTION 9

N.T.S.



LEGEND:

- INDICATES APPROXIMATE LOCATION AND EXTENTS OF SHALLOW CONCRETE REPAIR (SEE DETAIL 1/S-1). QUANTITY: 950 SF



SEAWALL REPAIR ELEVATION - SECTION 10

N.T.S.

SIMPSON GUMPERTZ & HEGER
 Engineering of Structures
 and Building Enclosures

Boston
 Chicago
 Houston
 Los Angeles
 New York
 San Francisco
 Washington, DC

Simpson Gumpertz & Heger Inc.
 800 Boylston Street, Suite 2320
 Boston, Massachusetts 02199
 main: 617.963.5400 fax: 617.963.5401
 www.sgh.com

Consultant

No.	Date	Description	By

**SEAWALL REPAIRS
 KING'S BEACH
 SWAMPSCOTT, MA**

Project

**SEAWALL REPAIR
 ELEVATIONS
 SECTIONS 9 & 10**

Drawing Title

Project No. 200603.00	Checked JGT	Date 07/10/2020
Drawn ZCL	Approved GGC	Scale AS NOTED
Seal		Drawing No. S-6

BID SET

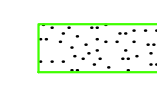

LEGEND:

 INDICATES APPROXIMATE LOCATION AND EXTENTS OF SHALLOW CONCRETE REPAIR (SEE DETAIL 1/S-1).

QUANTITY: 1050 SF



SEAWALL REPAIR ELEVATION – SECTION 11

N.T.S.

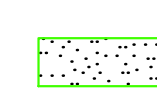

LEGEND:

 INDICATES APPROXIMATE LOCATION AND EXTENTS OF SHALLOW CONCRETE REPAIR (SEE DETAIL 1/S-1).

QUANTITY: 1150 SF



SEAWALL REPAIR ELEVATION – SECTION 12

N.T.S.

Simpson Gumpertz & Heger Inc.
800 Boylston Street, Suite 2320
Boston, Massachusetts 02119
Phone: 617.963.5400 Fax: 617.963.5401
www.sgh.com

Boston
Chicago
Houston
Los Angeles
New York
San Francisco
Washington, DC

Consultant

No.	Date	Description	By

**SEAWALL REPAIRS
KING'S BEACH
SWAMPSCOTT, MA**

Project

**SEAWALL REPAIR
ELEVATIONS
SECTIONS 11 & 12**

Drawing Title

Project No. 200603.00	Checked JGT	Date 07/10/2020
Drawn ZCL	Approved GGC	Scale AS NOTED

Drawing No.

S-7

Seal

BID SET



LEGEND:

- INDICATES APPROXIMATE LOCATION AND EXTENTS OF SHALLOW CONCRETE REPAIR (SEE DETAIL 1/S-1). QUANTITY: 900 SF
- INDICATES APPROXIMATE LOCATION AND EXTENTS OF DEEP CONCRETE REPAIR EXTENDING GREATER THAN 4 IN. FROM ORIGINAL FACE OF WALL (SEE DETAIL 2/S-1). QUANTITY: 100 SF



SEAWALL REPAIR ELEVATION – SECTION 13

N.T.S.



LEGEND:

- INDICATES APPROXIMATE LOCATION AND EXTENTS OF SHALLOW CONCRETE REPAIR (SEE DETAIL 1/S-1). QUANTITY: 1500 SF



SEAWALL REPAIR ELEVATION – SECTION 14

N.T.S.

SIMPSON GUMPERTZ & HEGER
 Engineering of Structures
 and Building Enclosures

Boston
 Chicago
 Houston
 Los Angeles
 New York
 San Francisco
 Washington, DC

Simpson Gumpertz & Heger Inc.
 800 Boylston Street, Suite 2320
 Boston, Massachusetts 02199
 main: 617.963.5400 fax: 617.963.5401
 www.sgh.com

Consultant

BID SET

No.	Date	Description	By

**SEAWALL REPAIRS
 KING'S BEACH
 SWAMPSCOTT, MA**

Project

**SEAWALL REPAIR
 ELEVATIONS
 SECTION 13 & 14**

Drawing Title

Project No. 200603.00	Checked JGT	Date 07/10/2020
Drawn ZCL	Approved GGC	Scale AS NOTED
Seal		Drawing No. S-8

